



City of North Port
 Neighborhood Development Services
 4970 City Hall Blvd.
 North Port, FL 34286



Phone (941) 429-7055

Fax (941) 429-7180

Email: bldginfo@cityofnorthport.com

Inspections (855) 941-4636

APPLICATION FOR TREE REMOVAL PERMIT

Permit No. _____

Parcel ID _____ Lot _____ Block _____ Addition _____

Property Owner	Contractor
Address	Address
Phone	Phone
Email	License No.
	Email

Reason for Removal

to facilitate construction unhealthy tree(s)

Other (specify) _____

Number & Types of trees to be removed _____

Instructions for preparing a site plan

1. Indicate the exact location of each tree to be saved or removed on each site plan.
2. Two (2) color coded copies of the site plan are required with each Tree Removal Application.
3. Use a boundary survey or aerial photo from the Sarasota County Property Appraiser.
4. Mark trees to be removed with a **colored ribbon**.

I assume Legal responsibility for any and all violations on this property pertaining to the City of North Port Tree Protection Regulations, Ordinance No. 02-16, for the duration of the permit or until the permit is closed.

 Print Name of Owner or Authorized Agent submitting this Application

 Signature

Phone No. _____

Date _____

Office Use Only

APPROVED This Application is approved in accordance with Chapter 45 of the City's Unified Land Development Code Ordinance No. 02-16

Adjacent Lots _____

CONDITIONS

The tree removal permit shall be posted on the jobsite prior to any work being performed. The construction authorization card shall remain located on the property until final inspection is approved.

DENIED

 Authorized Signature

 Date

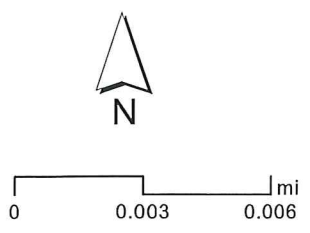
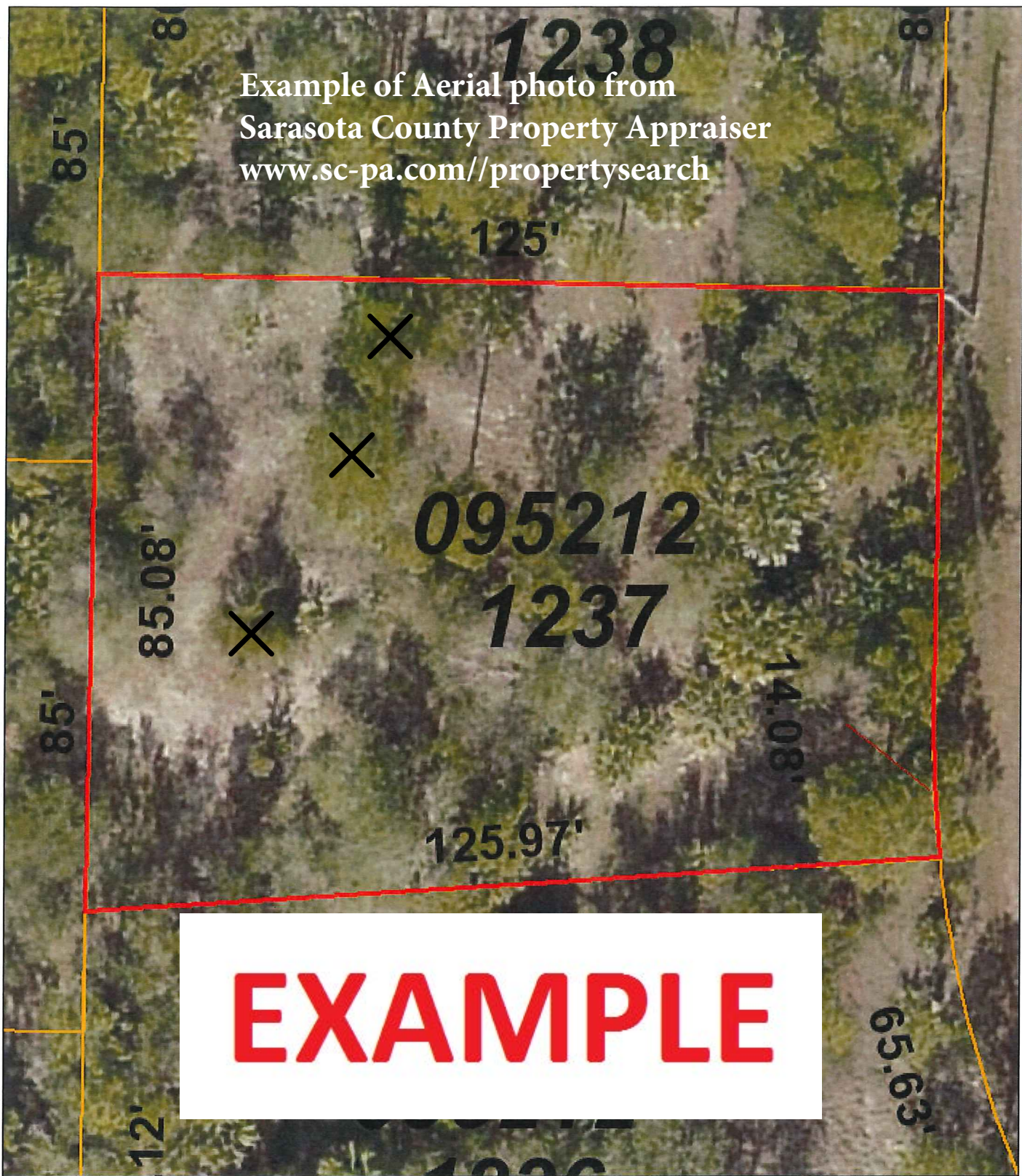

Bill Furst
SARASOTA COUNTY
PROPERTY APPRAISER

This map is a product of the Sarasota County Property Appraiser's Office. No warranties are expressed or implied.